

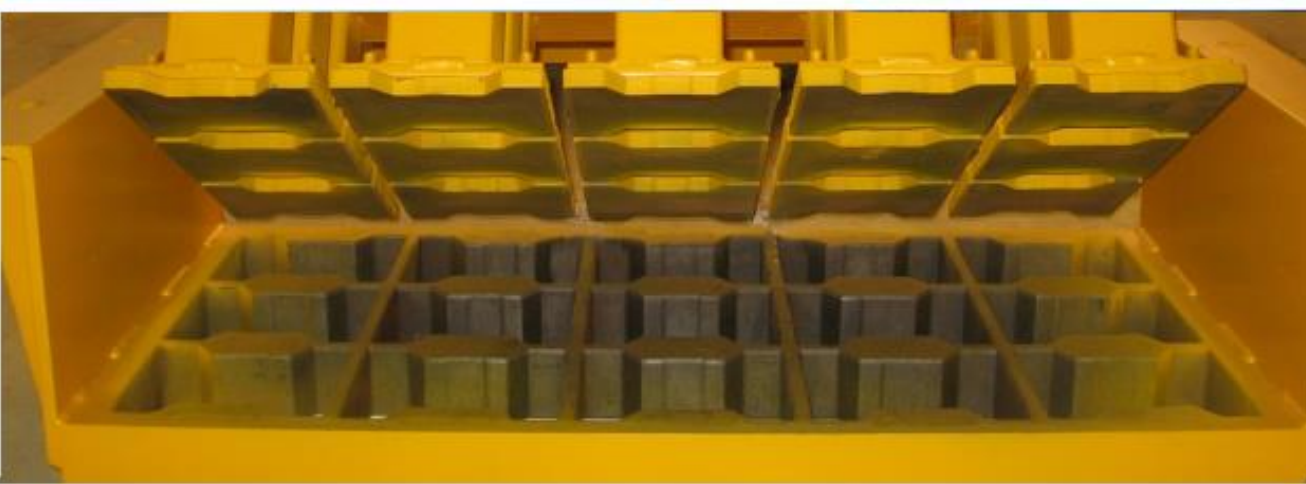

**CATALOGO
STAMPI PAVÈ**

**PAVER MOULDS
CATALOGUE**

**CATALOGUE
MOULES PAVÉ**



Block Machines & Moulds



Com'è fatto uno stampo da pavé.

Innanzitutto è fatto di 2 parti: un'anima e una parte di carpenteria.

L'anima cosiddetta è fatta di acciaio FE S355 rettificato, viene tagliata a ossitaglio una lastra dal pieno. Griglia e pressatori sono carbonitrurati (subiscono un trattamento termico) e raggiungono una durezza di 62-64 HRC.

La carpenteria è fatta di acciaio FE 370. Le parti sono saldate a filo e fresate a misura. Viene infine fatta la foratura di aggancio macchina. Ogni stampo nasce con la sua pressa, e non possono essere divise.

Tutta questa cura per rendere i nostri stampi durevoli, resistenti ed affidabili. Seguite attentamente le istruzioni d'uso nei manuali delle blocchiere per assicurarvi di farli lavorare al meglio e per molti anni.

Vi presentiamo alcuni stili di pavé che abbiamo prodotto negli anni, non tutti! Se avete un disegno che volete riprodurre fateci avere uno schizzo e faremo uno stampo fatto apposta per voi!

Comment est fabriqué un moule pavé.

Tout d'abord il est composé de 2 parties : un noyau et une partie menuiserie. Le noyau dit est en acier FE S355 rectifié, une brame est découpée par oxycombustible. La grille et les presseurs sont carbonitrurés (ils subissent un traitement thermique) et atteignent une dureté de 62-64 HRC.

La menuiserie est en acier FE 370. Les pièces sont soudées au fil et fraisées sur mesure. Enfin, le perçage pour l'attelage de la machine est réalisé. Chaque moule naît avec sa presse, et ils sont indivisibles.

Tout ce soin pour rendre nos moules durables, résistants et fiables. Suivez attentivement les instructions d'utilisation dans les manuels des machines à blocs pour vous assurer qu'ils fonctionneront au mieux et pendant de nombreuses années.

Voici quelques styles de pavé que nous avons produits au fil des ans, pas tous ! Si vous avez un dessin que vous souhaitez reproduire, laissez-nous un croquis et nous fabriquerons un moule rien que pour vous !

How a paver mould is made.

First of all it is made up of 2 parts: a core and a carpentry part.

The so-called core is made of rectified FE S355 steel, a slab is cut by oxyfuel. Grid and pressers are carbonitrided (they undergo a heat treatment) and reach a hardness of 62-64 HRC.

The carpentry is made of FE 370 steel. The parts are wire welded and milled to size. Finally, the drilling for coupling to the machine is made. Each mould is born with its press, and they cannot be divided.

All this care to make our moulds durable, resistant and reliable. Carefully follow the instructions for use in the manuals of the block machines to ensure that they will work at their best and for many years.

Here are some paver styles we've produced over the years, not all! If you have a design you want to reproduce, let us have a sketch and we will make a mould just for you!

MOD.040 – RETTANGOLO

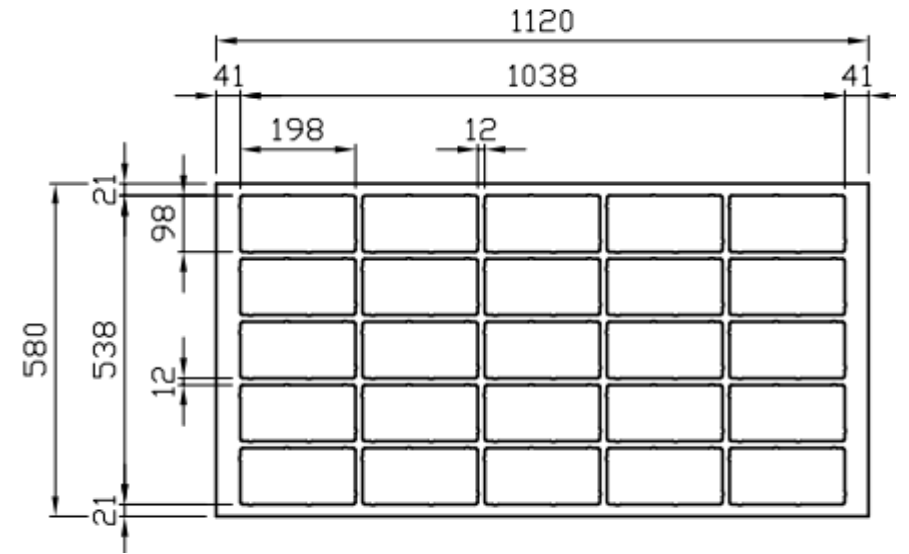
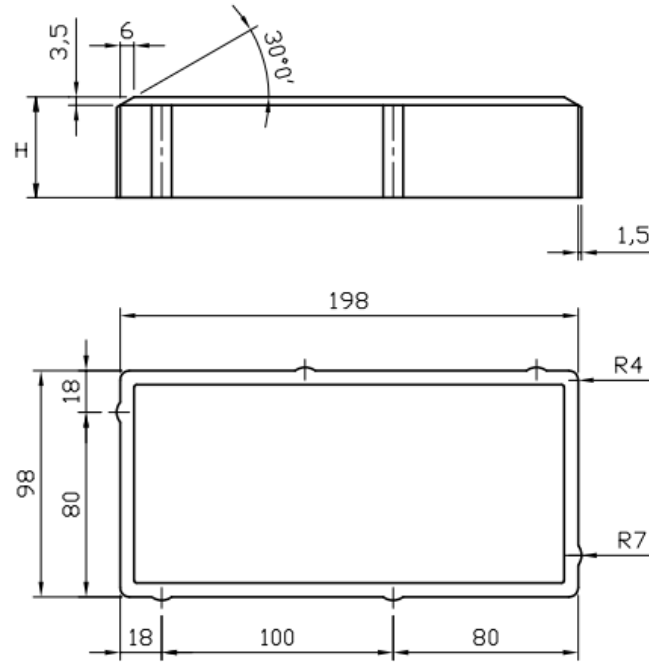
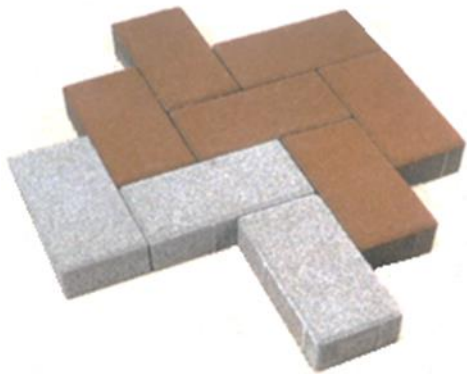
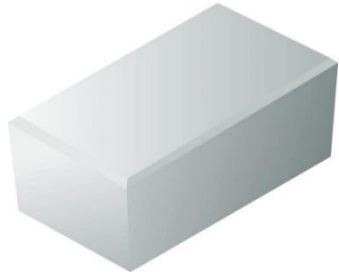

Ex. Mould for S1010

DIMENSIONS

cm ²	PCS X 100m ²
194	5155

ELEMENTI PER STAMPATA – PIECES PAR MOULE – PIECES PER MOULD

C25	S510	S610 SR610	S1010 SR1053	M515	M150
10	10	15	25	15	25

MOD.190 – DOUBLE T

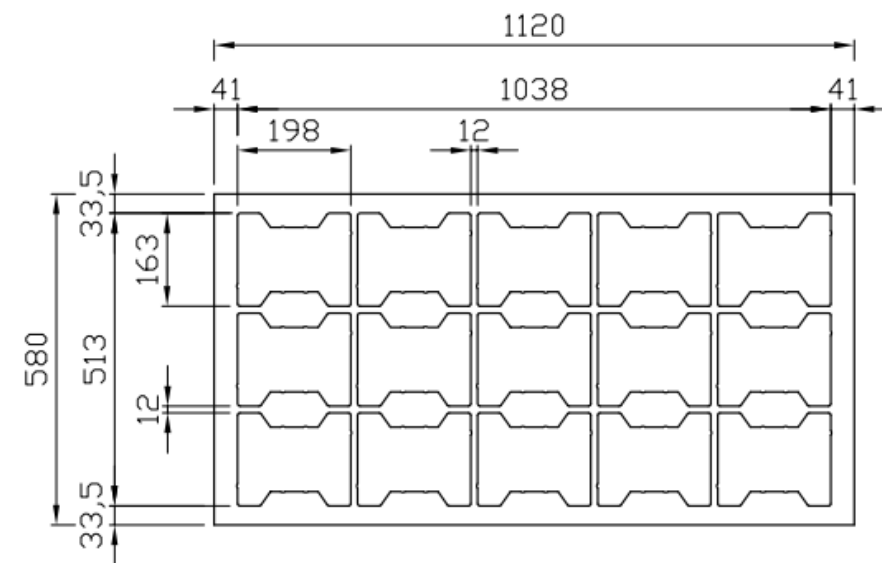
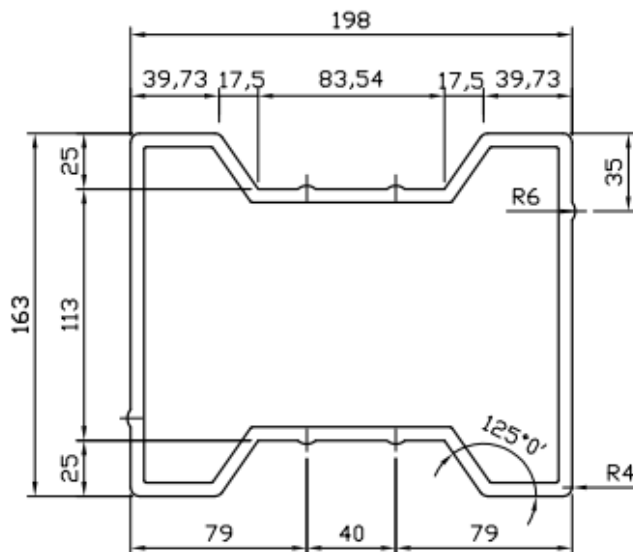
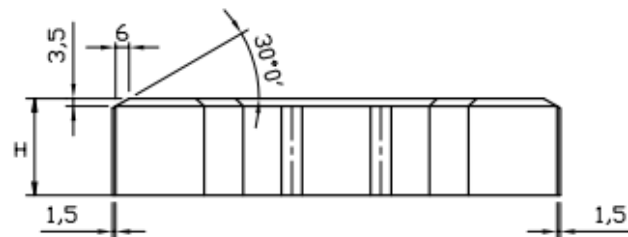
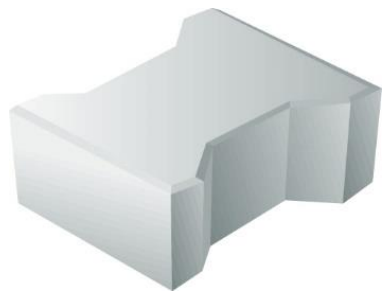

Ex. Mould for S1010

DIMENSIONS

cm ²	PCS X 100m ²
271,2	3688

ELEMENTI PER STAMPATA – PIÈCES PAR MOULE – PIÈCES PER MOULD

C25	S510	S610 SR610	S1010 SR1053	M515	M150
6	6	9	15	9	15

MOD.070 - ONDA

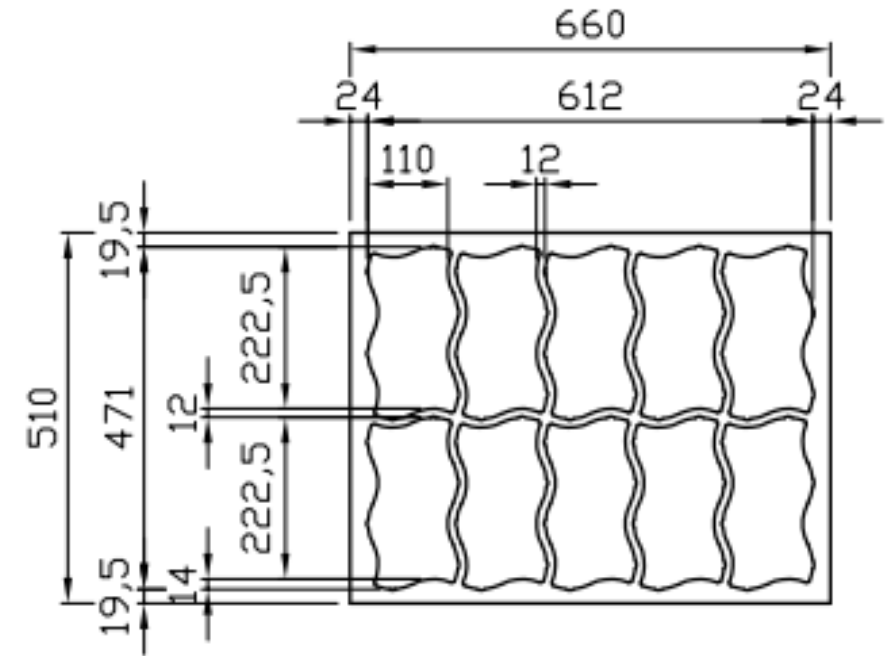
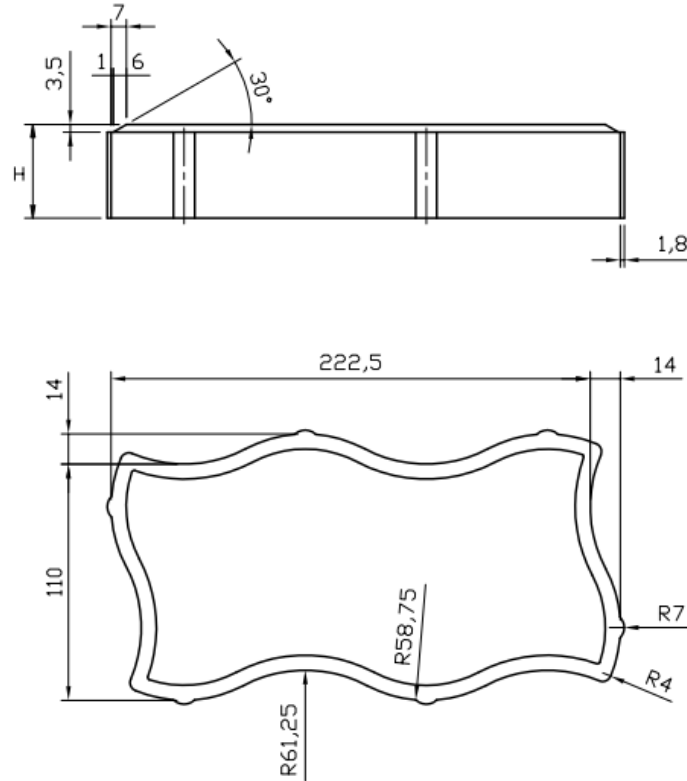
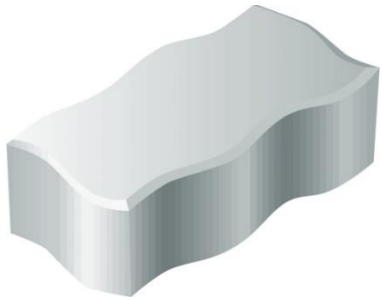

Ex. Mould for S610

DIMENSIONS

cm ²	PCS X 100m ²
242,8	4119

ELEMENTI PER STAMPATA – PIÈCES PAR MOULE – PIÈCES PER MOULD

C25	S510	S610 SR610	S1010 SR1053	M515	M150
6	6	10	16	10	16

MOD. 130 - ONDA²

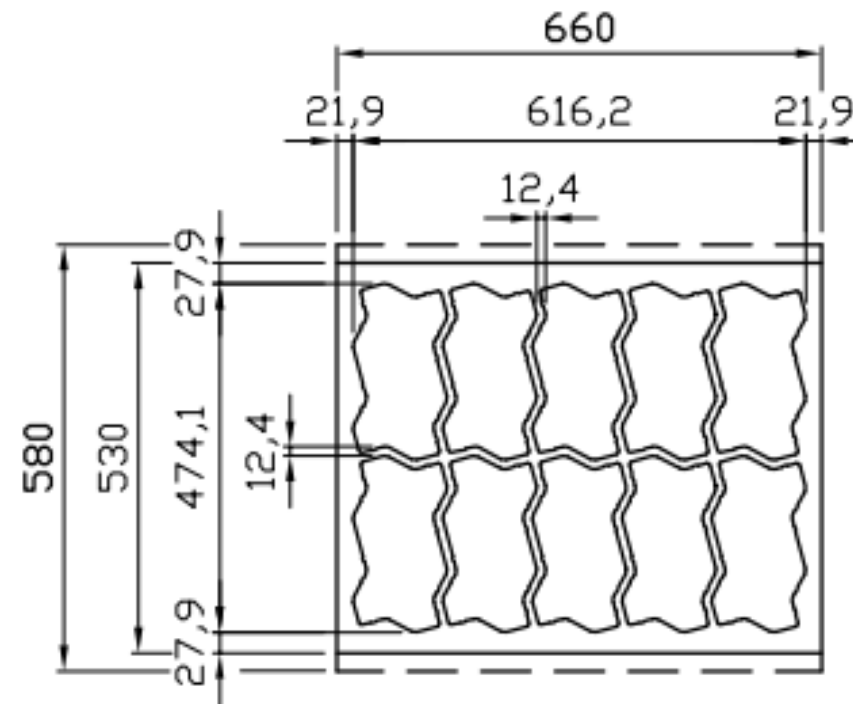
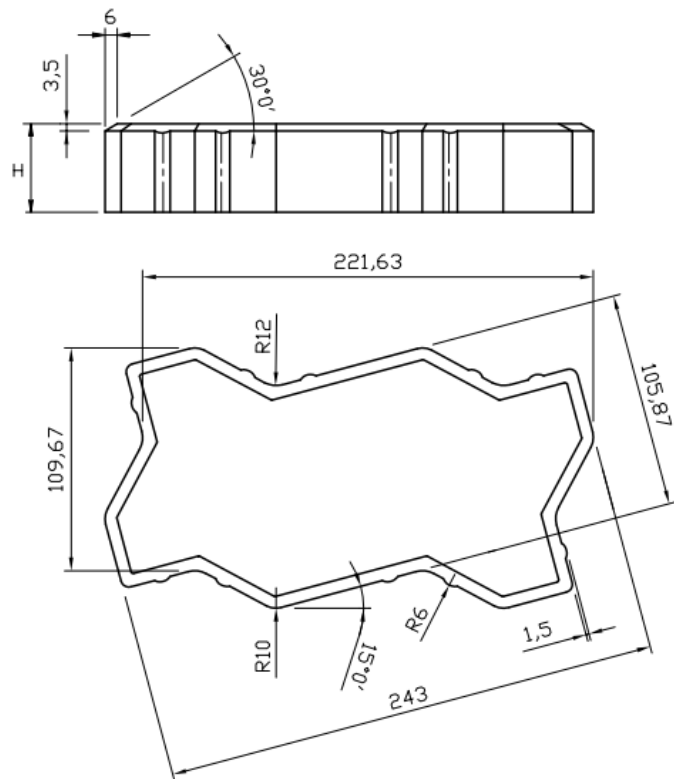
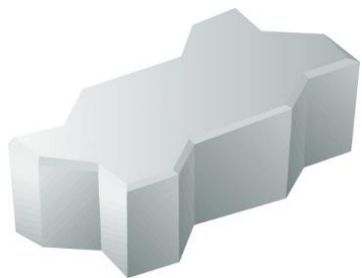

Ex. Mould for S610

DIMENSIONS

cm ²	PCS X 100m ²
243	4115

ELEMENTI PER STAMPATA – PIECES PAR MOULE – PIECES PER MOULD

C25	S510	S610 SR610	S1010 SR1053	M515	M150
6	6	10	16	10	16

MOD.580 – LOTUS

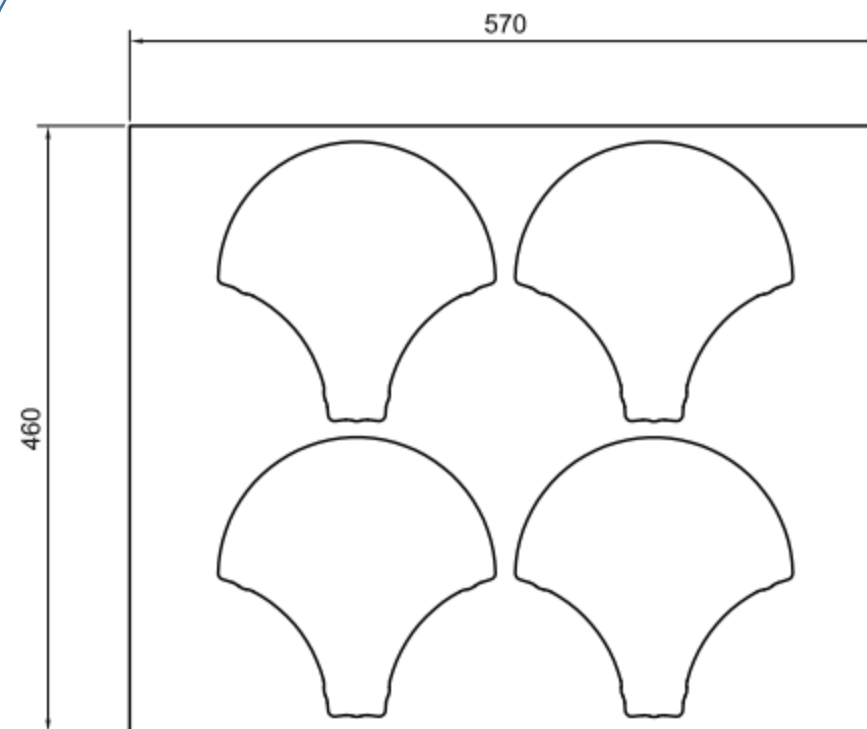
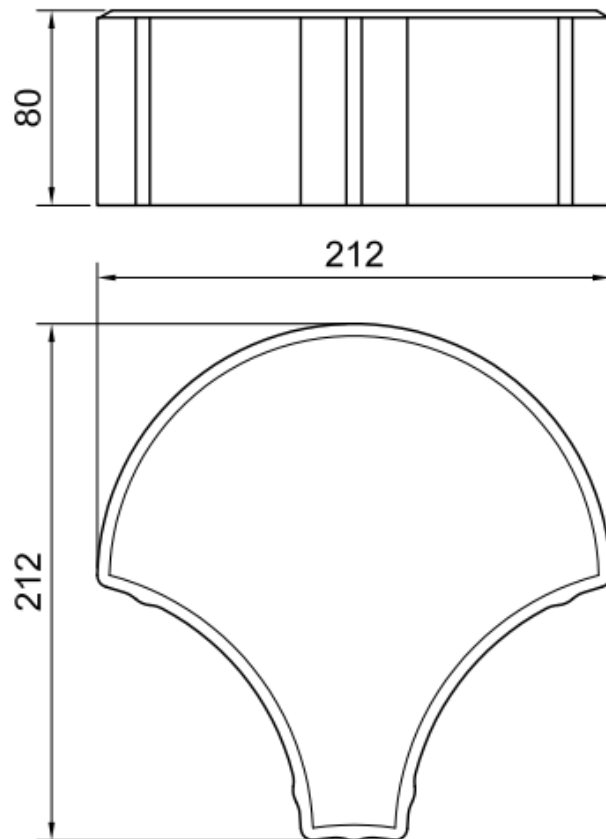

Ex. Mould for S510

DIMENSIONS

cm ²	PCS X 100m ²
277,2	3608

ELEMENTI PER STAMPATA – PIÈCES PAR MOULE – PIÈCES PER MOULD

C25	S510	S610 SR610	S1010 SR1053	M515	M150
4	4	6	10	6	10

MOD. 530 - CUBETTO

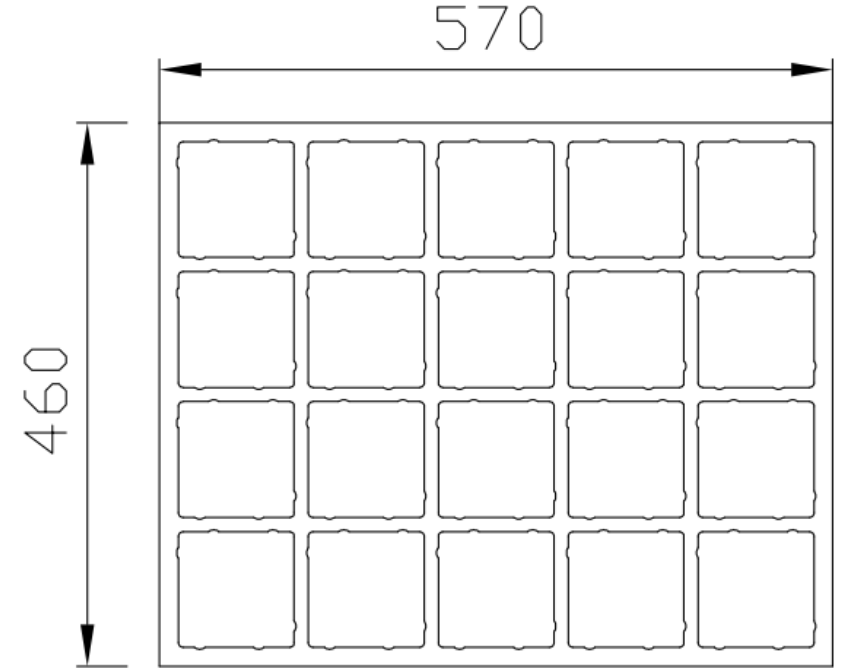
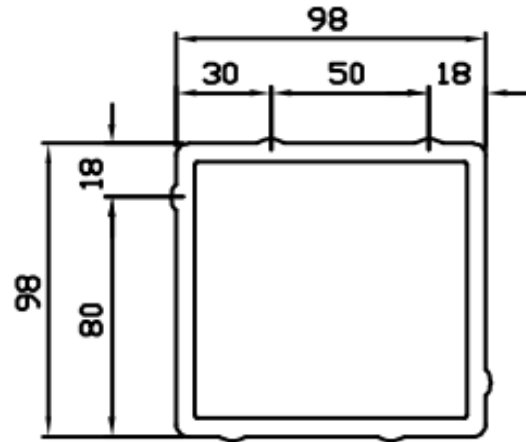
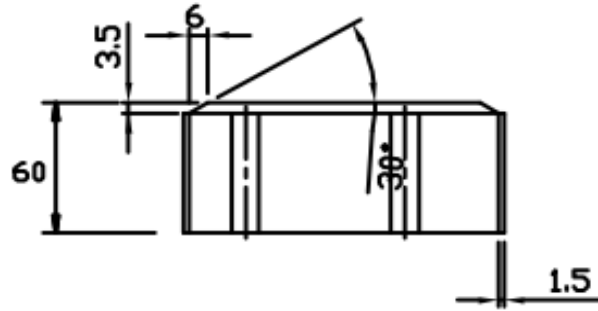
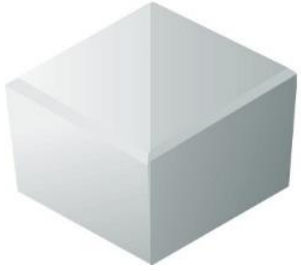

Ex. Mould for S510

DIMENSIONS

cm ²	PCS X 100m ²
96	10410

ELEMENTI PER STAMPATA – PIECES PAR MOULE – PIECES PER MOULD

C25	S510	S610 SR610	S1010 SR1053	M515	M150
25	20	42	50	28	50

MOD. 700 - TRIFO

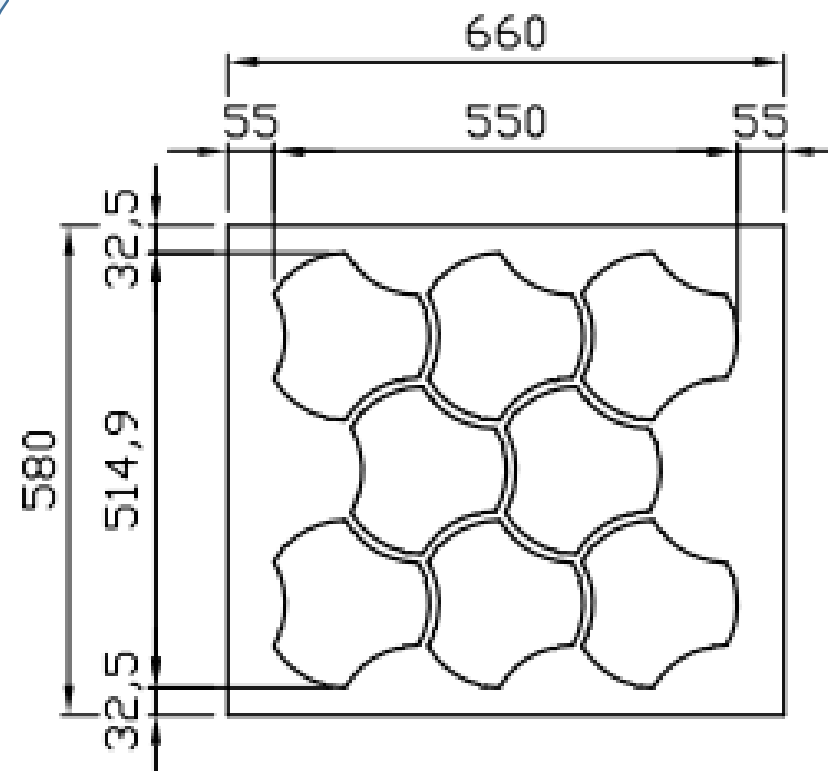
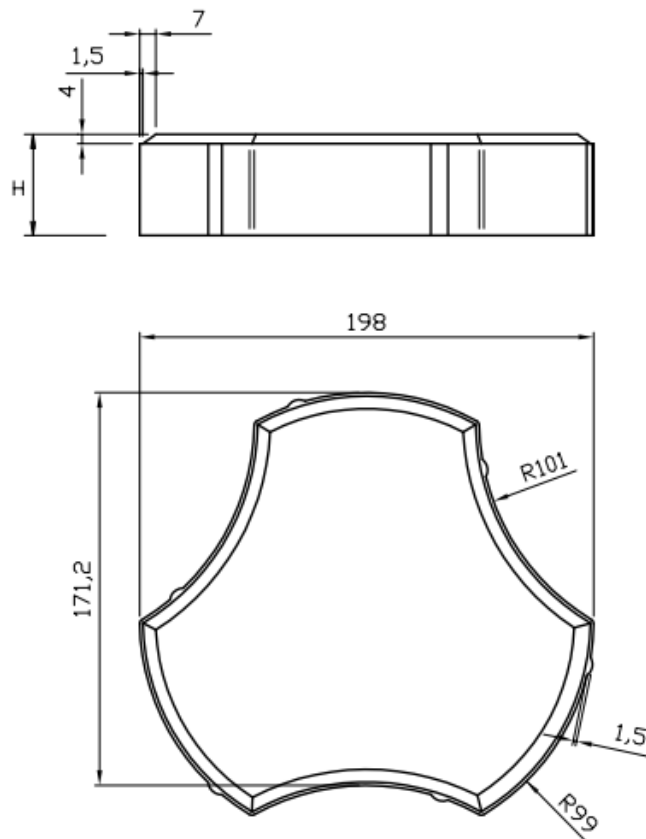

Ex. Mould for S610

DIMENSIONS

cm ²	PCS X 100m ²
255	3926

ELEMENTI PER STAMPATA – PIECES PAR MOULE – PIECES PER MOULD

C25	S510	S610 SR610	S1010 SR1053	M515	M150
8	8	8	12	8	12

MOD. 620 - HEXA

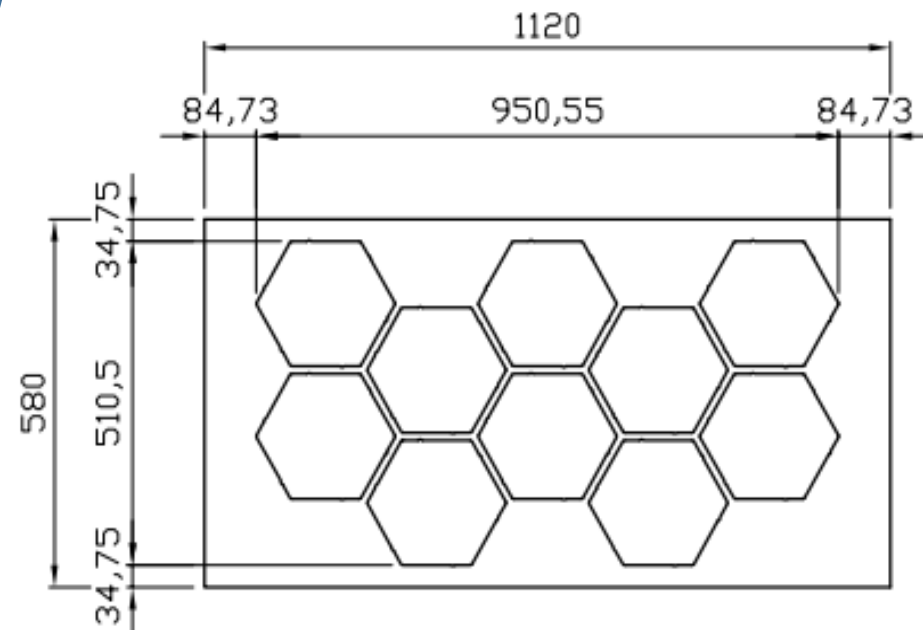
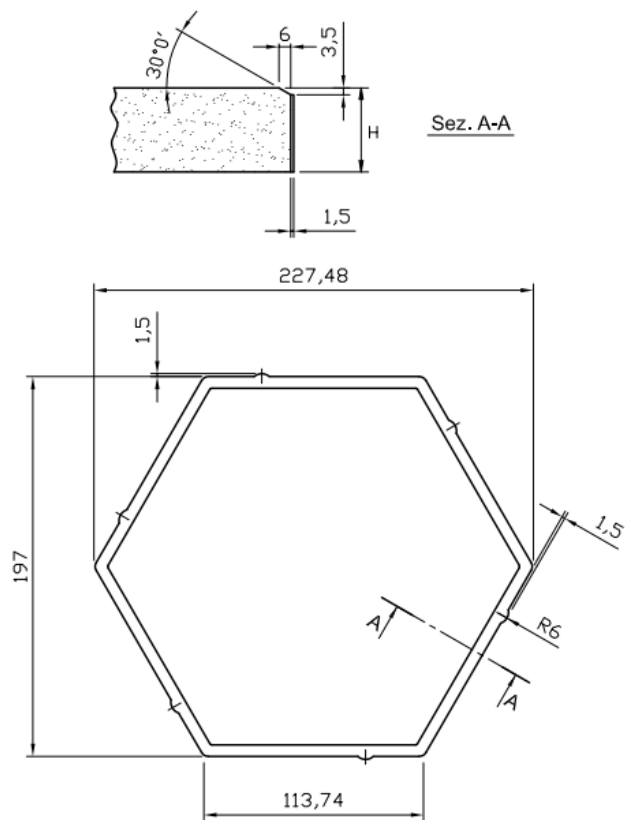
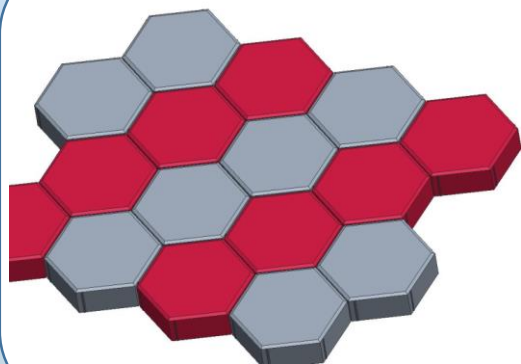
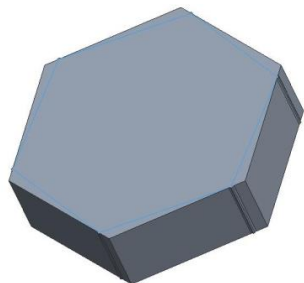

Ex. Mould for S1010

DIMENSIONS

cm ²	PCS X 100m ²
336	2976

ELEMENTI PER STAMPATA – PIECES PAR MOULE – PIECES PER MOULD

C25	S510	S610 SR610	S1010 SR1053	M515	M150
4	4	6	10	6	10

MOD. 360 – HEXA2

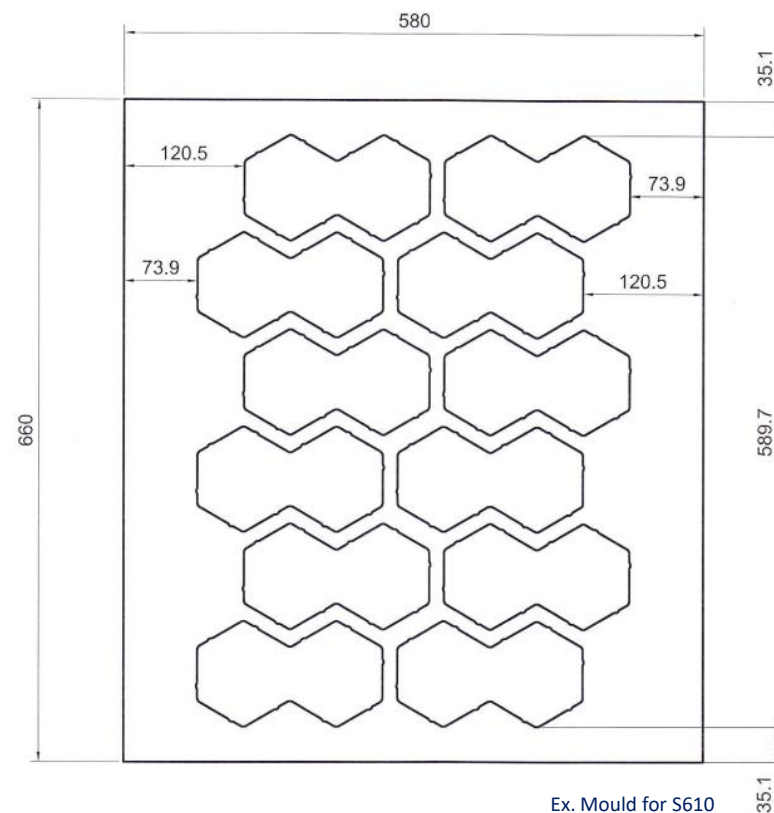
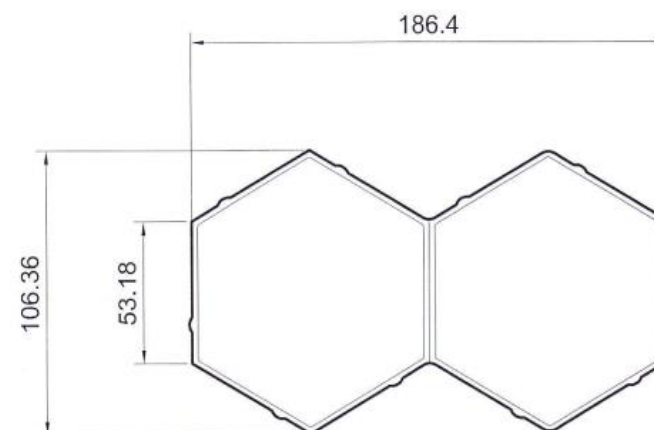
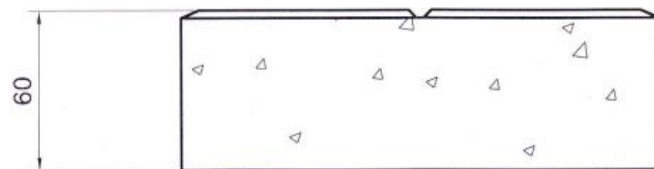
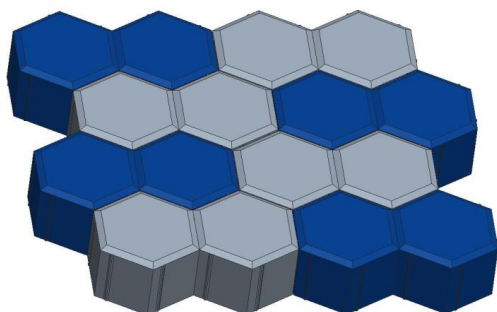
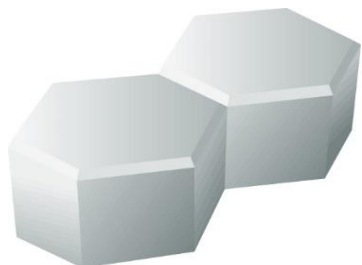

DIMENSIONS

cm ²	PCS X 100m ²
147,4	6783

ELEMENTI PER STAMPATA – PIÈCES PAR MOULE – PIÈCES PER MOUL

C25	S510	S610 SR610	S1010 SR1053	M515	M150
8	8	12	20	12	20

MOD. 680 – HEXA3

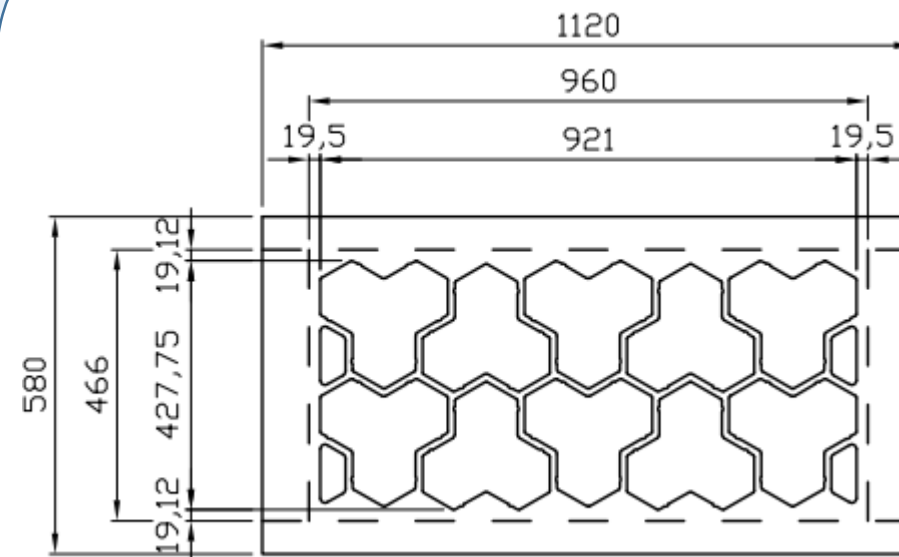
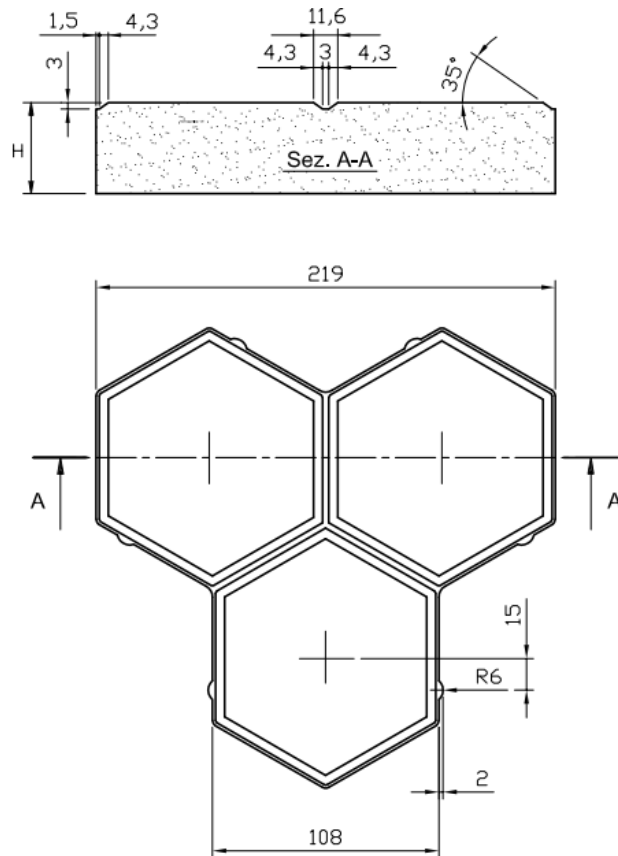
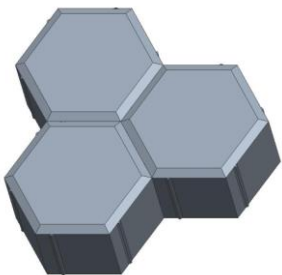

Ex. Mould for S1010

DIMENSIONS

cm ²	PCS X 100m ²
	3800

ELEMENTI PER STAMPATA – PIECES PAR MOULE – PIECES PER MOULD

C25	S510	S610 SR610	S1010 SR1053	M515	M150
4	4	6	10	6	10

MOD. 290 - PACMAN

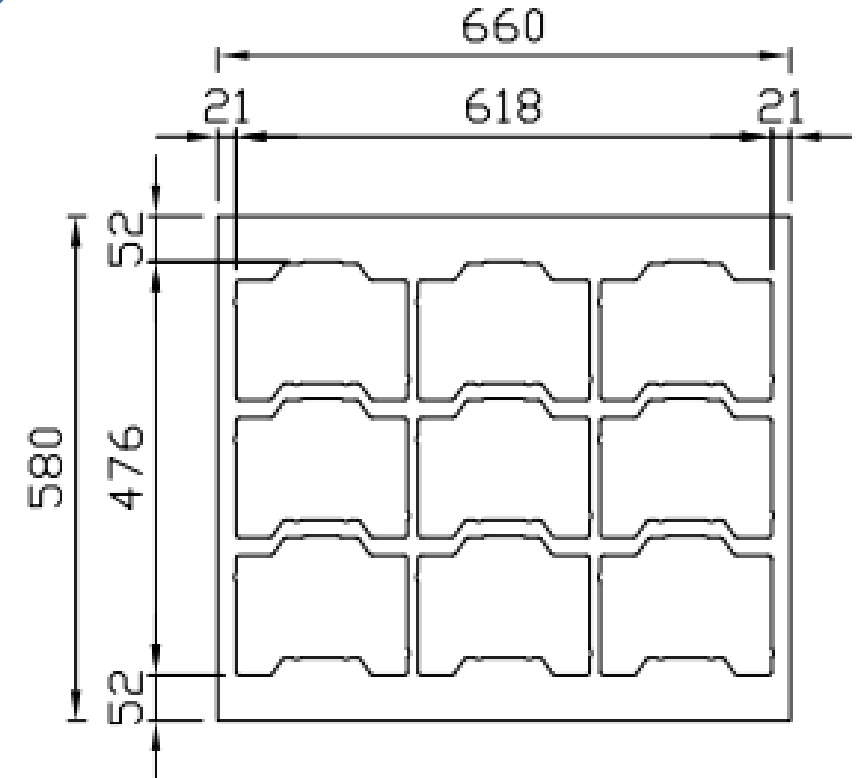
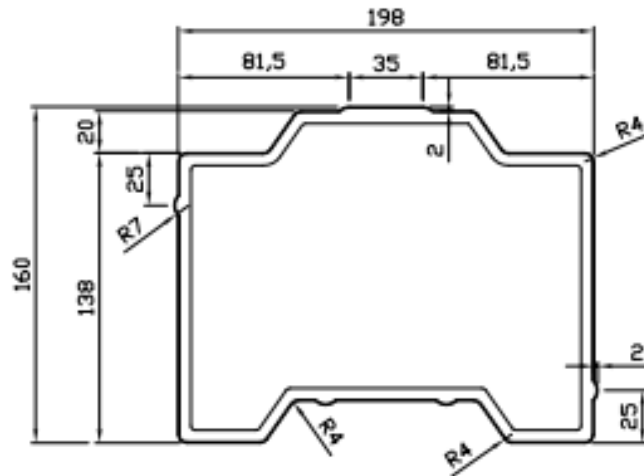
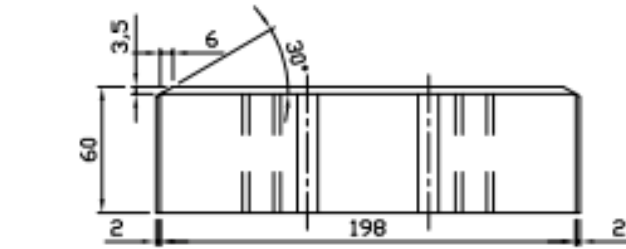
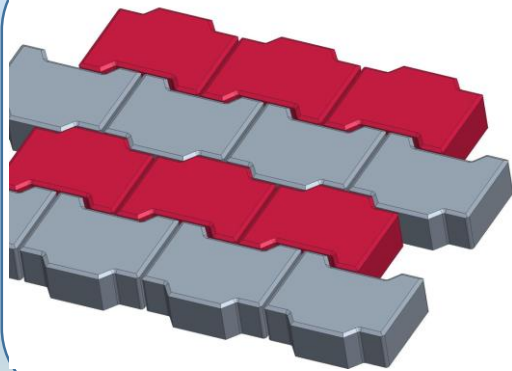
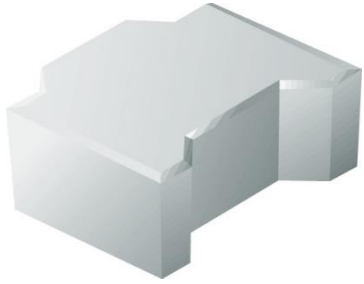

Ex. Mould for S610

DIMENSIONS

cm ²	PCS X 100m ²
286	3500

ELEMENTI PER STAMPATA – PIÈCES PAR MOULE – PIÈCES PER MOULD

C25	S510	S610 SR610	S1010 SR1053	M515	M150
4	4	9	15	9	15

MOD. 200 - COMBO

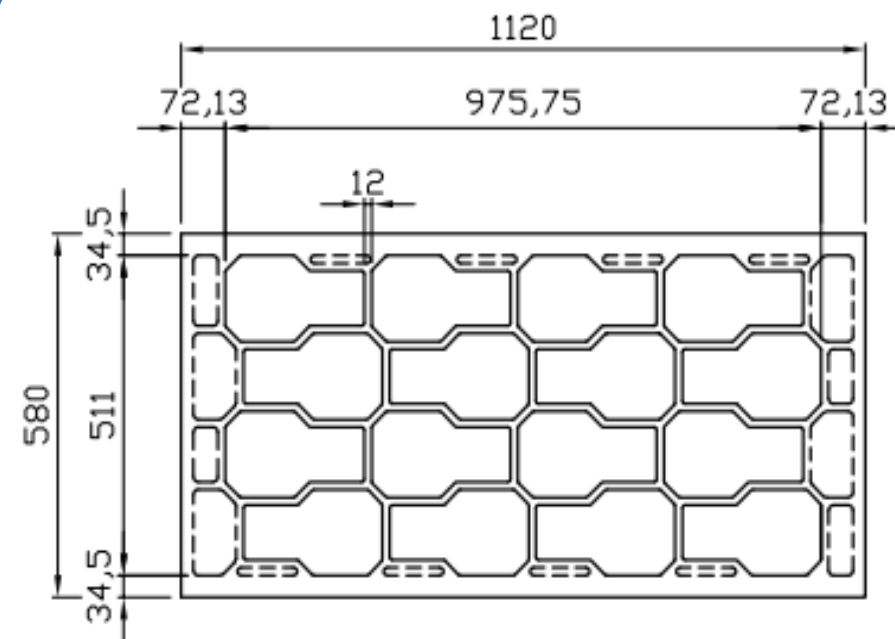
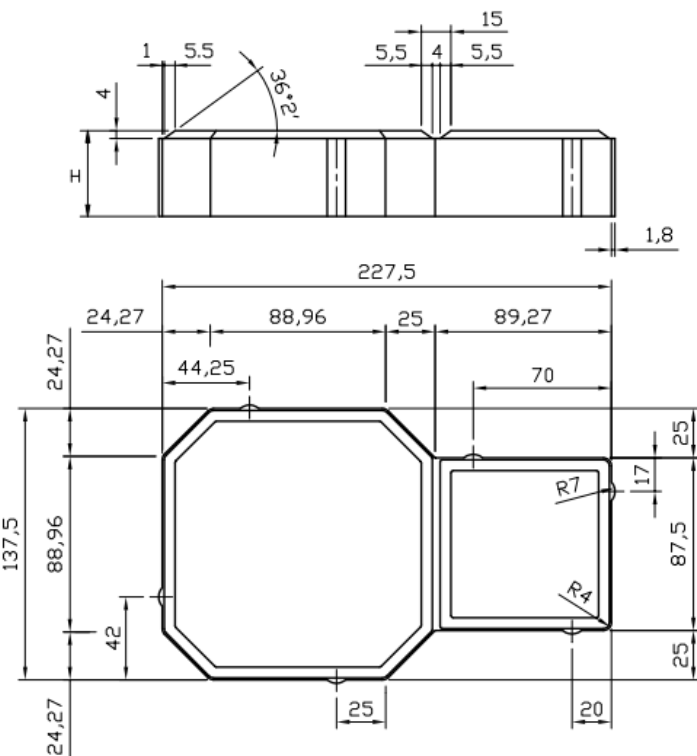
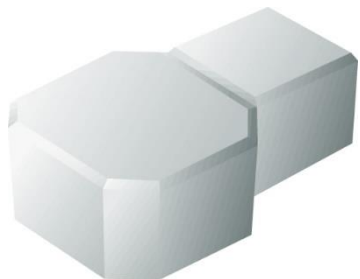

Ex. Mould for S1010

DIMENSIONS

cm ²	PCS X 100m ²
264	3788

ELEMENTI PER STAMPATA – PIECES PAR MOULE – PIECES PER MOULD

C25	S510	S610 SR610	S1010 SR1053	M515	M150
6	6	8	16	8	16

MOD. 570B - BAROC

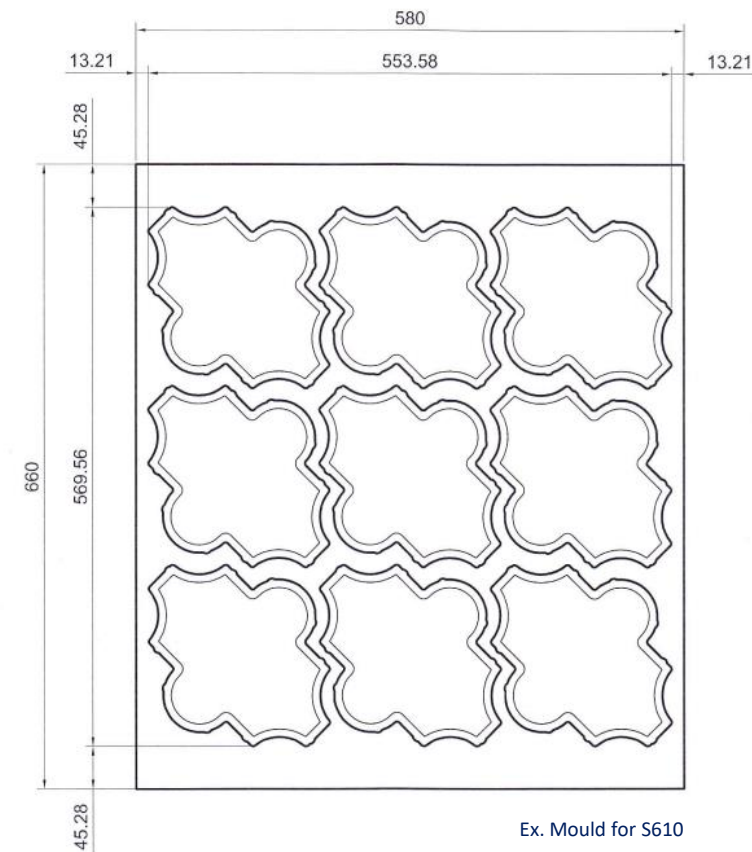
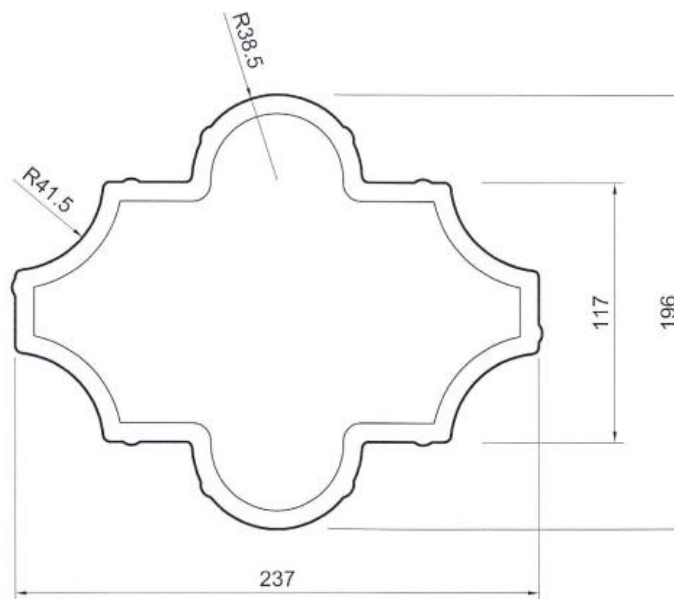
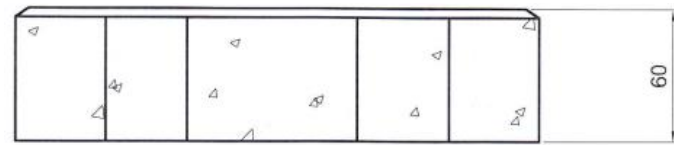
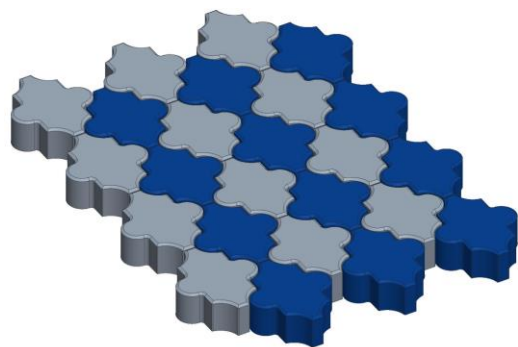

DIMENSIONS

cm ²	PCS X 100m ²
266,64	3750

ELEMENTI PER STAMPATA – PIECES PAR MOULE – PIECES PER MOULD

C25	S510	S610 SR610	S1010 SR1053	M515	M150
4	4	9	18	9	18

MOD. TRIEFF

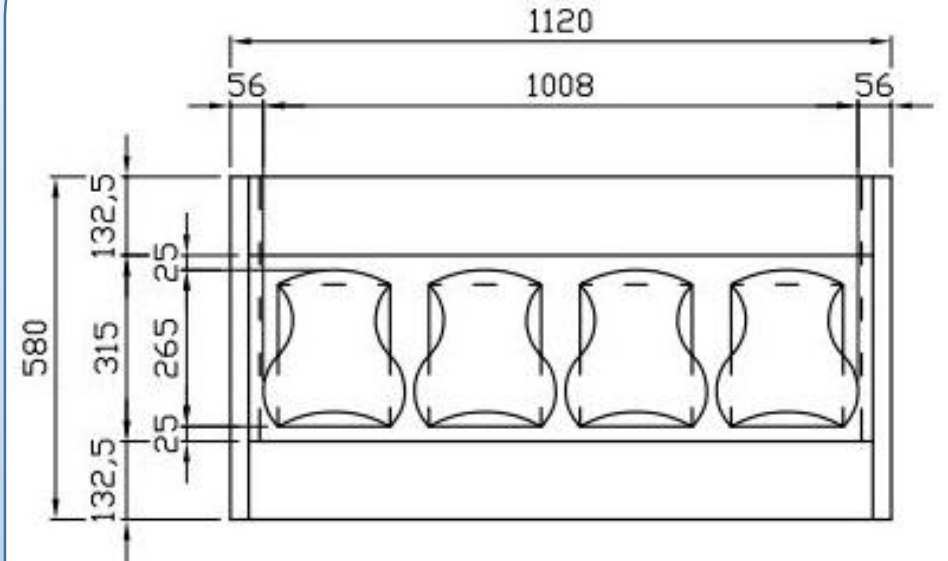
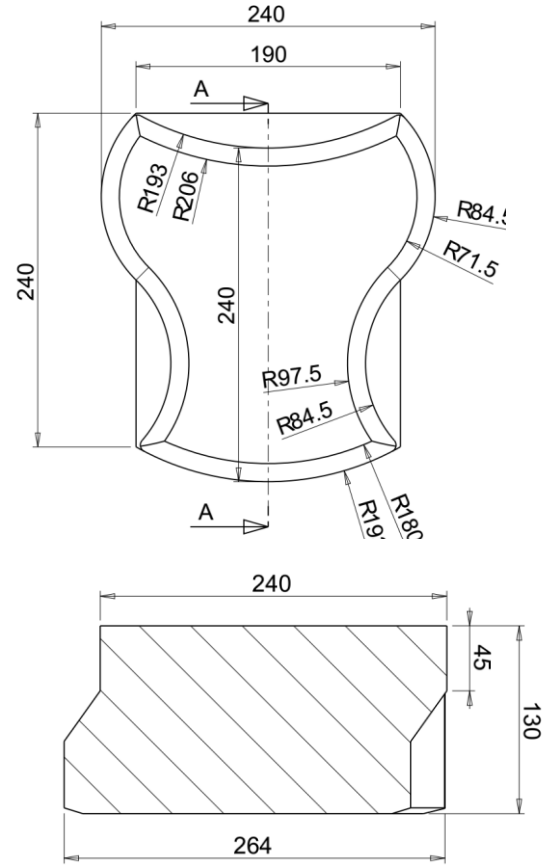
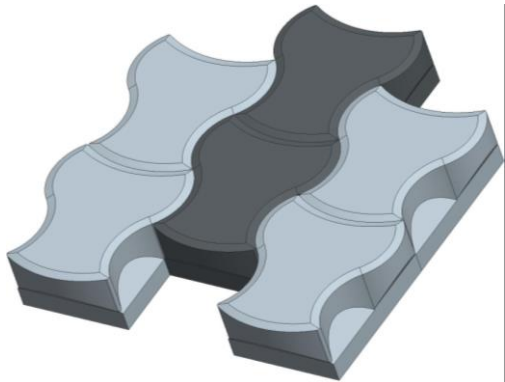

Ex. Mould for S1010

DIMENSIONS

cm ²	PCS X 100m ²
456	1600

ELEMENTI PER STAMPATA – PIÈCES PAR MOULE – PIÈCES PER MOULD

C25	S510	S610 SR610	S1010 SR1053	M515	M150
2	2	2	4	-	-

MOD. ERBOSO 1

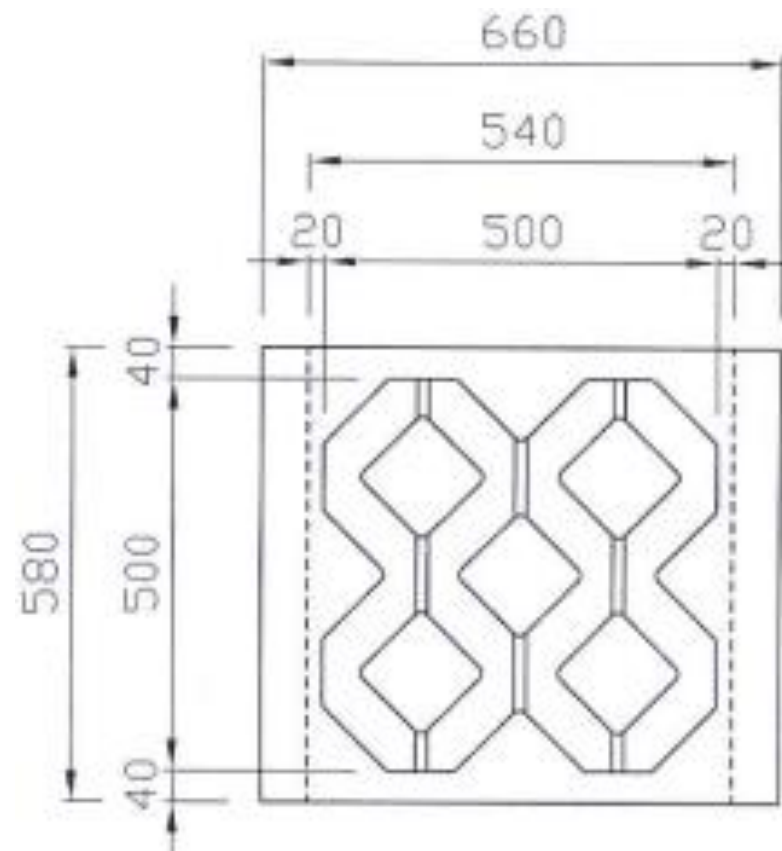
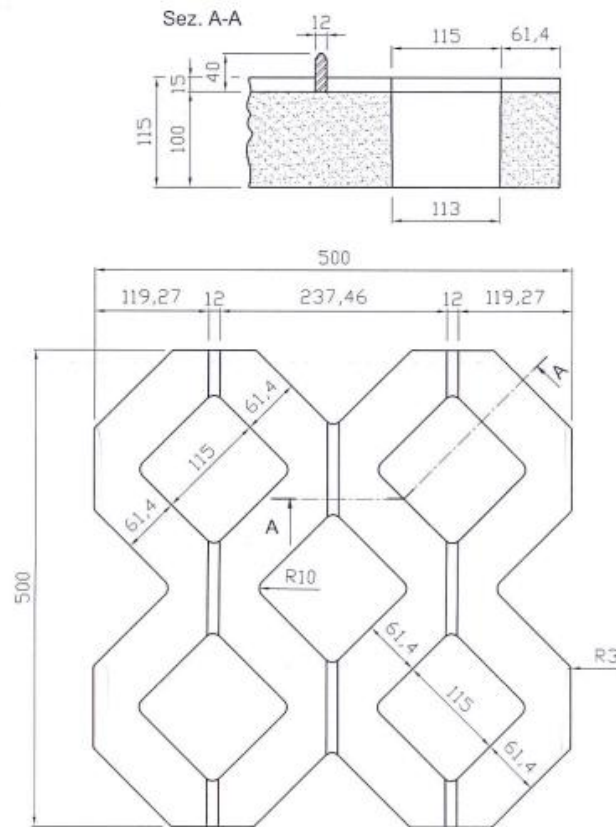

ELEMENTI PER STAMPATA – PIECES PAR MOULE – PIECES PER MOULD

C25	S510	S610 SR610	S1010 SR1053	M515	M150
1	1	1	2	1	2

MOD. ERBOSO 2

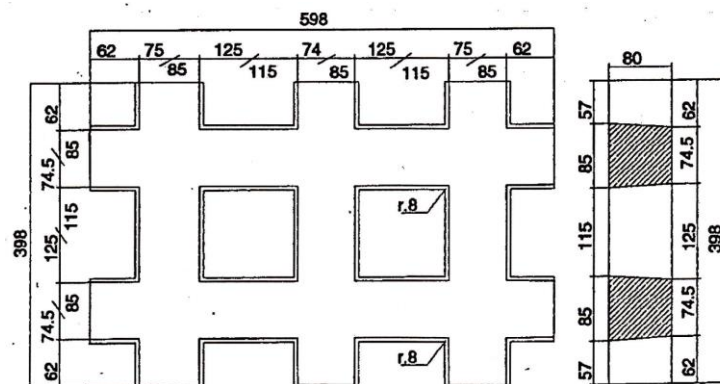
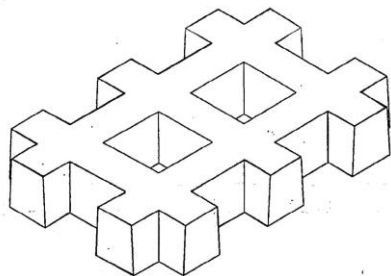

ELEMENTI PER STAMPATA – PIECES PAR MOULE – PIECES PER MOULD

C25	S510	S610 SR610	S1010 SR1053	M515	M150
1	1	1	2	1	2

MOD. ERBOSO 3

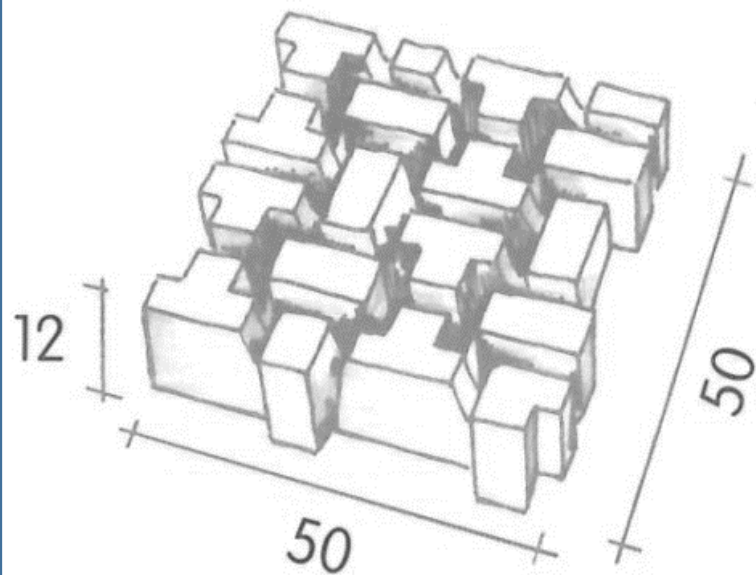

ELEMENTI PER STAMPATA – PIECES PAR MOULE – PIECES PER MOULD

C25	S510	S610 SR610	S1010 SR1053	M515	M150
1	1	1	2	1	2

SOME MORE DESIGNS FOR YOU TO CHOOSE...
ENCORE DES STYLES A VOTRE DISPOSITION...

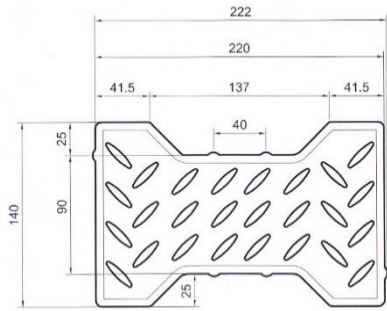

«barley top»

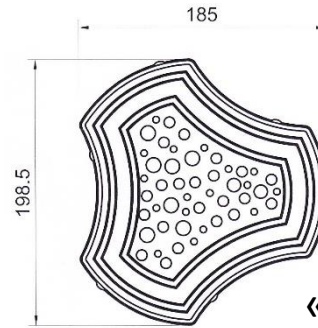

«bubble top»



«safety step»

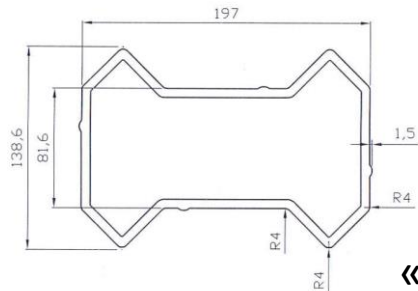

«dumbbell»

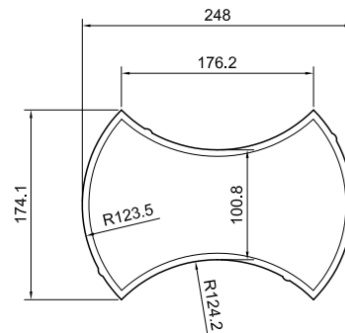

«axe»

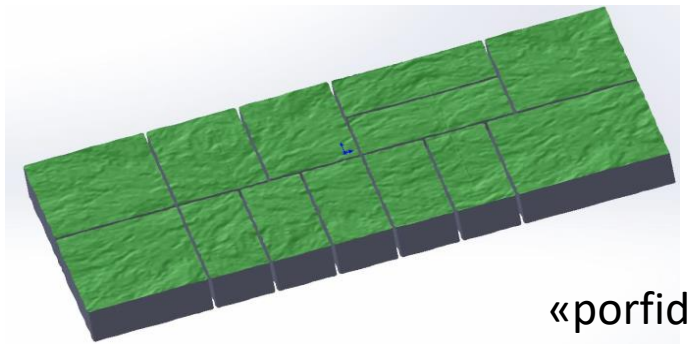

«porfido»

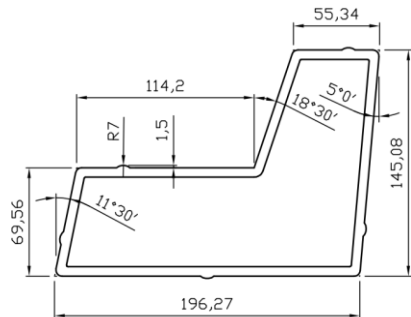

«bras»

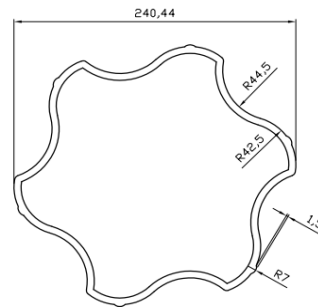

«rosetta»

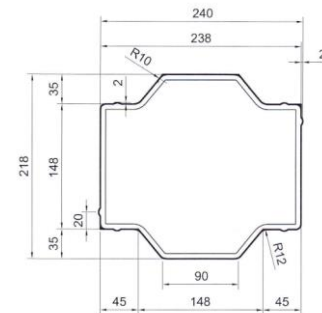

«handbag»



CADONA' SRL

VIA TRIESTINA, 97
30024 MUSILE DI PIAVE (VE) ITALIA

TEL. +39 0421 52278
INFO@CADONA.IT
WWW.CADONA.IT



CADONÀ

Block Machines & Moulds